



PEN MARINE

# 2017 Princess S60

GBP 960,000 (USD 1,300,000)



## Specification

Length Overall	19.17 m (62 ft 11 in)	Engine	2 x MAN V8-1200 hp
Beam	4.87 m (16 ft 0 in)	Engine Hours	525 Hours
Draft	1.40 m (4 ft 7 in)	Drive Type	SHAFT DRIVE
Cabins	3 ( 2 Guests + 1 Crew)	Fuel Tank	3,200 [L] - 845 [US GAL]
Hull Material	FIBERGLASS	Water Tank	603 [L] - 159 [US GAL]
Location	PENANG, MALAYSIA	Builder	PRINCESS YACHTS



## Description

The **Princess S60** is a striking blend of sportiness and elegance, crafted with the renowned British craftsmanship of Princess Yachts. Its sleek profile and dynamic lines reflect performance-driven design, while the spacious interior offers comfort and sophistication.

With three luxurious cabins, a well-appointed saloon, and expansive outdoor living areas, the S60 is perfect for entertaining or long-range cruising. Powered by twin MAN V8 engines, it delivers exhilarating speed and smooth handling, enhanced by advanced stabilisation systems.

More than a yacht, the Princess S60 is a lifestyle statement — combining power, precision, and luxury for unforgettable journeys.

### Key Features:

- Sleek, sporty exterior with dynamic profile
- Three guest cabins plus crew accommodation
- Expansive saloon with panoramic views
- Seakeeper Gyro Stabiliser for comfort at sea
- Advanced navigation and docking systems
- Premium interior finishes with customizable options



PEN MARINE

# General Arrangement

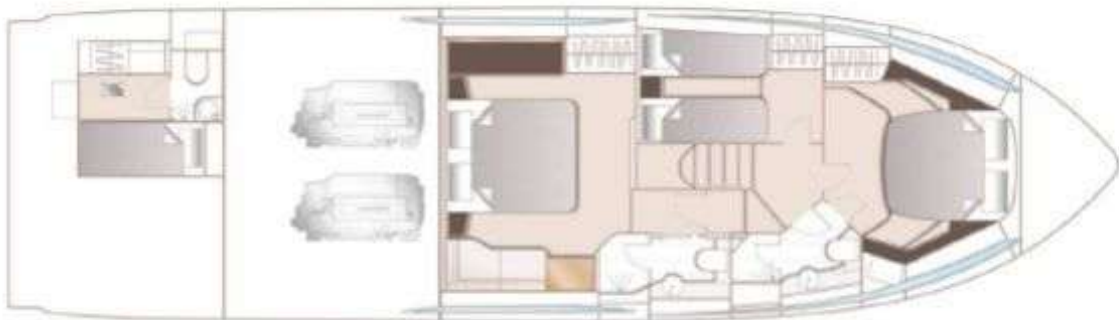
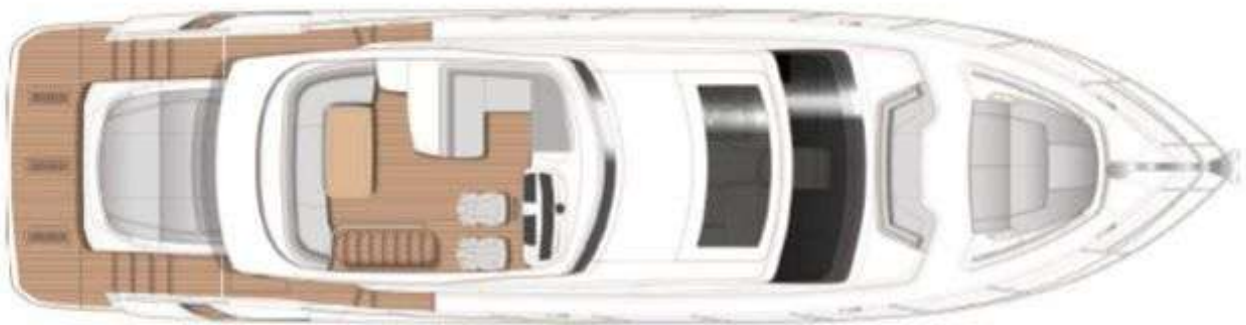





**PEN MARINE**



**PEN MARINE SDN BHD** (Co. No. 23640-X)  
3A - 1 - 12 Straits Quay, Seri Tanjung Pinang,  
Tanjung Tokong, 10470 Pulau Pinang, Malaysia.

[info@penmarine.com](mailto:info@penmarine.com)  
[www.penmarine.com](http://www.penmarine.com)

**Tel:** +6012 488 0880  
**Tel:** +6019 488 1188





**PEN MARINE**



**PEN MARINE SDN BHD** (Co. No. 23640-X)  
3A - 1 - 12 Straits Quay, Seri Tanjung Pinang,  
Tanjung Tokong, 10470 Pulau Pinang, Malaysia.

[info@penmarine.com](mailto:info@penmarine.com)  
[www.penmarine.com](http://www.penmarine.com)

**Tel:** +6012 488 0880  
**Tel:** +6019 488 1188





**PEN MARINE**



**PEN MARINE SDN BHD** (Co. No. 23640-X)  
3A - 1 - 12 Straits Quay, Seri Tanjung Pinang,  
Tanjung Tokong, 10470 Pulau Pinang, Malaysia.

[info@penmarine.com](mailto:info@penmarine.com)  
[www.penmarine.com](http://www.penmarine.com)

**Tel:** +6012 488 0880  
**Tel:** +6019 488 1188





**PEN MARINE**



**PEN MARINE SDN. BHD. IS THE REGISTERED AGENT OF THE  
LANGKAWI INTERNATIONAL YACHT REGISTRY (LIYR)**

*New Yacht Registration (Private & Commercial), Entity Registration,  
Ownership Transfer, Yacht Name Change, Annual Tonnage Renewal,  
Deletion Certificate*

**PEN MARINE SDN BHD** (Co. No. 23640-X)  
3A - 1 - 12 Straits Quay, Seri Tanjung Pinang,  
Tanjung Tokong, 10470 Pulau Pinang, Malaysia.

[info@penmarine.com](mailto:info@penmarine.com)  
[www.penmarine.com](http://www.penmarine.com)

**Tel:** +6012 488 0880  
**Tel:** +6019 488 1188



# PEN MARINE

MALAYSIA • THAILAND • SINGAPORE • INDONESIA • CHINA

This document is not contractual. Any information provided by the company on their website, brochure and any other related documentation is provided in good faith and offered for information purposed only and the company do not make any representation, warrant or assume any legal liability or responsibility whatsoever, express or implied, for the accuracy, adequacy, validity, reliability, availability, completeness or usefulness of any information and/or images displayed. Yacht inventory, sales and / or charter prices, and any other specifications are subject to changes at any time without prior notice. None of the text and/or image used in this brochure may be reproduced without written consent from the company.