

# 2008 Sunseeker Manhattan 60

USD 600,000



Length Overall	19.5 M	Engine	2 X Man V8-900 1800 HP
Beam	4.1 M	Engine Hours	N/A
Draft	1.45 M	Drive Type	Inboard Drive Type
Cabins	3 + 1 Crew	Fuel Tank	1,500 L
Hull Material	Fiberglass	Water Tank	400 L
Location	Hong Kong	Builder	Sunseeker

# SUNSEEKER MANHATTAN 60

*This stunning vessel is one of Sunseeker's most popular models, the Manhattan 60. Its spacious cockpit and saloon, panoramic flybridge and three cabins ensure a comfortable yet sporty ride for the guests. The owner has employed three full-time crew members to look after the boat since the current ownership, they have done an excellent job in maintaining the lovely Manhattan 60 and remains in great condition for a boat at this age.*



# GENERAL ARRANGEMENT

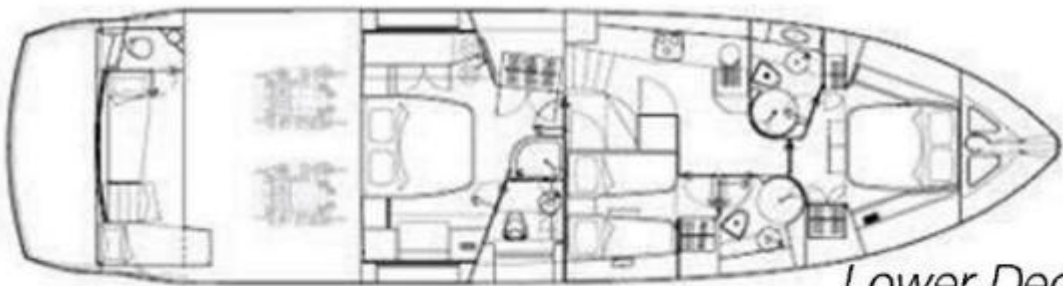

*Lower Deck*

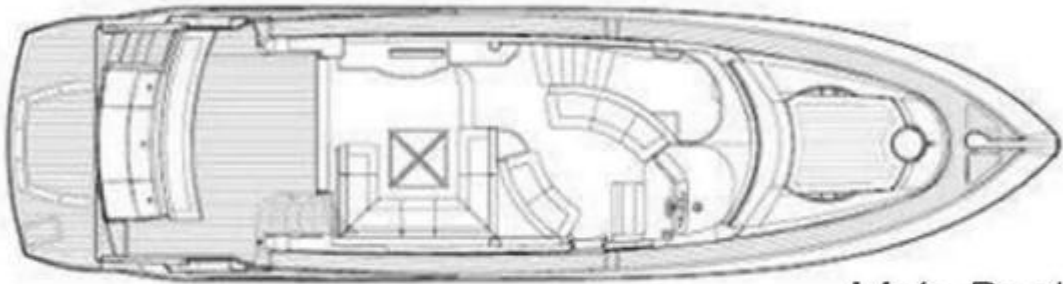

*Main Deck*

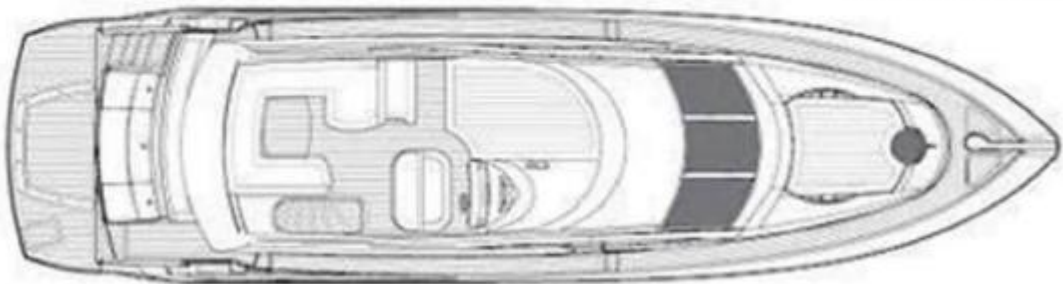

*Upper Deck*





# GALLERY

*EXPERIENCE THE SUNSEEKER MANHATTAN 60*











































**24V SYSTEM MONITORING**



DC METER  
V  
A  
C  
CE

**BATTERY CHARGER CONTROL**

24V CHARGER 12V CHARGER

OFF ON OFF ON

**12V SYSTEM MONITORING**



DC METER  
GENSET DC VOLTS x  
12.7V  
V  
A  
C  
CE

**AC POWER SYSTEM MONITORING**

GENERATOR SHORE POWER

RUNNING STOPPED

GENERATOR SELECTED SHORE POWER SELECTED



AC METER  
PANEL AC VOLTS x  
0V  
V  
A  
Hz  
CE

BOAT POWER DISTRIBUTION

**GENERATOR CONTROL**

START / STOP

EMERGENCY START CROSSOVER

HOURS 3 1904

ELTIME HOURS

**FRESH WATER CONTROL**

HEATER PUMP

OFF OFF



**BLACK WATER CONTROL**

OFF

PUMP OUT

FULL 3/4 FULL PUMPING SEACOCK OPEN