

# 2000 Oceanco Motoryacht, Friendship

EUR 14,750,000



Length Overall	52.80 M	Engine	2 X MTU 12V396TE74 diesels @ 1,750 HP Each
Beam	9.45 M	Engine Hours	N/A
Draft	3.80 M	Drive Type	Shaft drive
Cabins	7 Cabins (Including Captain's Cabins)	Fuel Tank	110,800 L
Hull Material	Steel	Water Tank	26,200 L
Location	Western Mediterranean / Viareggio	Builder	Oceanco (Holland)



## 1. CONSTRUCTION

Steel hull, aluminum superstructure, teak decks

## 2. DIMENSIONS

### 2.1 General

Length Overall:	173.24 feet	(52.80 meters)
Beam:	31.00 feet	( 9.45 meters)
Draft (loaded):	12.47 feet	( 3.80 meters)
Tonnage:	643 gross; 192 net tons	

### 2.2 Capacities

Fuel Capacity:	29,291 US Gallons (110,800 liters)	
Water Capacity:	6,900 US Gallons ( 26,200 liters)	
Watermakers:	6,340 US Gallons ( 24,000 liters)	
Lube Oil:	240 US Gallons ( 910 liters)	
Waste Oil:	240 US Gallons ( 910 liters)	
Grey Water:	2,800 US Gallons ( 10,600 liters)	
Black Water:	391 US Gallons ( 1,480 liters)	

### 2.3 Speed

		Consumption per hours	Range	RPM
Maximum:	16.1 knots	730 liters (193 US Gal)		2,000
Cruising:	14.5 knots	450 liters (119 US Gal)		1,750
Economical:	12.4 knots	335 liters ( 66 US Gal)	5,100 nm	

Average consumption including Genset: 335 liters (88.5 US gallons) per hour

## 3. MACHINERY

### 3.1 Main Engines

Engine Type:	• (2) MTU 12V396TE74 diesels @ 1,750 Hp each
Gearboxes for Main Engines:	• ZF BW-461
Drive:	• Twin screw propellers

### 3.2 Generators & Electricity

Output:	• 400V/3 Phase/50 Hz / 230V/Single Phase/50 Hz
Generators:	• (2) 142 kW MTU/Mercedes 8V1831
	• (1) Lister/Petter TS33BV3 emergency generator
Generator Fuel Consumption:	• 335 liters (88.5 US gallons) per hour
Shore Power:	• 400V/3 Phase/50 Hz
Batteries:	• 5 Banks 24VDC

### 3.3 Air Conditioning

Type:	• Heinen & Hopman/Marine Air 75 ton
-------	-------------------------------------

### 3.4 Other Machinery

Watermakers:	• (2) HEM 30/3200 1000 liters (264 US gallons)
per hour	
Stabilizers:	• Running - Vosper
	• At anchor - (2) Quantum Zero Speed
Bow Thruster:	• Rexroth
Steering System:	• Cramm/Rexroth
Fuel Separator & Filtration:	• Racor filters and Alfa Laval MMPX 303 SGP-11
separator	
Sewage System:	• Haman Norway Mini
Fresh Water System:	• (3) Hydrophore pumps and accumulator
Rudder Angle Indicator:	• Anschutz
Bilge Water Filtration:	• Johnson CH 40-200
Oil/Water Separator:	• Hodges 9422
Boilers:	• (2) ACV E-Tech 22
WCs:	• Evac



#### 4. COMMUNICATION, NAVIGATION & ENTERTAINMENT SYSTEMS

##### 4.1 Communication Systems

- SATcom:
  - (2) Thrane & Thrane Fleet 77
- VSAT:
  - (2) Sea Tel V-Sat broadband terminals 4006 and 4003 with VOIPs
- Telephone System:
  - Panasonic KX-TDKX1232
- SSB Radio:
  - Furuno FS-2575-C
- VHF Radiotelephones:
  - (2) Furuno FM-8900S
  - (15) Icom portables
- GPIRB:
  - (2) Jotron 40S and ACR Global Fix Pro
- AIS:
  - (1) Furuno FA-170
- Light Signal:
  - (1) Astralux 0019
- Cellular Phone System:
  - Roaming GSM and V-Sat VOIP
- Intercom:
  - Door phone system
- Starlink Maritime with two antennas

##### 4.2 Navigation Systems

- Radar:
  - (1) Furuno FR2105 X-Band
  - (1) Furuno RCU-025 S-Band (Brand new)
- Gyrocompass:
  - Anschutz Standard 24 with TMC (twin)
- Magnetic Compass:
  - Cassens & Plath Delta-Pilot
- Auto Pilot:
  - Anschutz NP2010 type AP01-SO1
- Depth Sounder:
  - Furuno FCV-582L
- Log:
  - Ben Marine Anthea RGD100
- GPS:
  - (2) Northstar 952X
- Ships Computer:
  - (6) HP Laptops
  - (3) Apple computers
  - (2) Officejet 7610
  - (1) Canon MG5650
  - Transas
- Photocopier/Printer:
  - (2) B&G Hydra 2000
- Chart Plotter:
  - (1) Furuno NX700
- Wind/Speed Log:
  - Raytheon Ray 430
- Navtex:
  - KahlenbergT-3 with M-511 whistle control
- Loudhailer:
  - (2) B&G Hydra 2000
- Air Horns:
  - (1) Furuno NX700

##### 4.3 Entertainment System

- A. Video Equipment
  - Full Kaleidescape system / Full Apple-TV with iPad controls in all guest and crew areas with flat screens throughout.
  - Wireless network and hard-wired network
  - Satellite television throughout the boat and in all cabins.
- TVs:
  - State-of-the-art audio-visual systems throughout the boat and in all cabins. All new in refit 2015 at MB92
- B. Audio Equipment
  - State-of-the-art audio-visual systems throughout the boat and in all cabins. All new in refit 2015 at MB92
- Stereos:
  - State-of-the-art audio-visual systems throughout the boat and in all cabins. All new in refit 2015 at MB92
- C. Wi-Fi Internet Access
  - Both V-Sat and roaming 4G GSM

#### 5. GALLEY & LAUNDRY EQUIPMENT

##### 5.1 Main Galley Equipment

- Cooking Equipment:
  - (2) MKN Hans Dampf Pro Steamer ovens
  - (1) Techoinox salamander
  - (6) Miele cook plates CS1222
  - (1) Panasonic NE 1456 stainless microwave
- Refrigeration/Freezer:
  - (3) Heinen Hopman stainless refrigerator
  - (1) Heinen Hopman stainless walk-in freezer
- Dishwasher:
  - (2) Winterhalter UC
- Other:
  - (1) Dumbwaiter-Main deck pantry
  - (1) Broan 8251T-03 trash compactor
  - (1) Scotsman AC-45 icemaker

##### 5.2 Crew Galley/Mess Equipment

- Cooking Equipment:
  - (1) Miele M8151-2 microwave
- Refrigeration/Freezer:
  - (1) Miele FD 9004 refrigerator
- Other:
  - (1) Broan 8251T-03 trash compactor

##### 5.3 Additional Galley Equipment

- Cooking Equipment:
  - (1) Miele M8151-2 microwave (upper pantry)
  - (1) Solaire infrared gas BBQ grill (sun deck)
- Refrigeration/Freezer:
  - (1) Miele FD 9004 refrigerator (main deck pantry)
  - (1) Miele K 9552ID refrigerator (upper pantry)
  - (1) Custom drawer refrigerator (sun deck)
- Other:
  - (1) Scotsman AC45 icemaker in main deck and upper deck pantry and (1) on sun deck
  - (1) Nespresso coffee machine (main deck pantry)
  - (1) Dumbwaiter (upper deck pantry)
  - (1) Carpigianni frozen yogurt machine (upper deck pantry)

##### 5.4 Laundry Equipment

- Main Laundry Equipment
  - (3) Miele Professional PW6065 Vario washers
  - (3) Miele Professional PT7136 Vario dryers
  - (1) Miele HN 5310 roller iron



## 6. TENDERS & TOYS

Tenders:

- (1) 19' Castoldi jet tender solas (new 2022)

Other:

- (2) SeaBob (new 2022)
- (2) Seadoo (new 2022)

Jacuzzi Dip Pools:

- (1) Scandi Aqualine on Owner's deck
- (1) Scandi Aqualine on sun deck

BBQ:

- (1) Solaire infrared gas grill on sun deck

## 7. DECK EQUIPMENT

Anchor Windlass System:

- (2) Muir VR1500

Aft Warping Capstans:

- (2) Muir VR1200

Anchors:

- (2) Pool fully balanced 585 kg

Anchor Chain:

- (6) shots of U2 24 mm stud link each side

Boat Crane and Davits:

- (2) 2 meter Ascon/Van Driel

Passerelle:

- Cramm

Side Boarding Ladders:

- Cramm hydraulic starboard side

Searchlight:

- 9-step Marquip Sea Stair

Awning:

- (1) Sanshin HRX-150

- (2) Retractable on sun deck

- (1) Fixed over Owner's private seating area forward

- (2) Windbreakers on Bridge deck aft

Gym Equipment:

- Nordic Track Elliptical

- (2) Lemond exercise bikes

- Nordic Track treadmill

- ProElix vibration machine

- Free weights (up to 40kg)

## 8. SECURITY, FIRE FIGHTING & SAFETY EQUIPMENT

### 8.1 Security Equipment

CCTV System:

- Elbex

Cameras:

- (7) security

Monitors:

- All around crew quarters

Ship's Safe:

- (7) Total onboard.

- (1) Owner's suite

- (1) Each of the five guest cabins

- (1) Captain's cabin

### 8.2 Fire Fighting Equipment

Fire Control System:

- Heinen & Hopman sprinkler system

Fire Extinguishers:

- Fixed Co2 in Galley, ER and Jetski pods.

- (22) 2kg powder

- (2) 6kg powder

- (9) 9L foam

- (1) 20kg Co2

- (2) 5kg Co2

- (2) 2 kg Co2

- (1) 9L Chemical foam

Alarms:

- Tyco Minerva fire addressable detection system

- MCS-5 alarm system

- Gas detection alarm for BBQ

- Gas detection for Jet ski pods

### 8.3 Safety Equipment

Life Rafts:

- Full complement of safety gear to more than comply with Flag, Lloyd's and MCA rules

Life Rings:

- (2) 25 persons and (1) 6-persons

- (10) 2x light and smoke

- (1) self-igniting light

- (7) 30m line

- (2)

EPIRBs:

- Smoke, rockets and flares

Flares:

Medical Equipment:

- Ocean going full Category A

EEBDs:

- (30) Oceanco M-20.2 and Drager CF10



## 9. ACCOMMODATIONS

Sleeps up to 12 guests in the Owner's party in 6 staterooms plus 7<sup>th</sup> stateroom on lower deck as gym / massage room, plus crew accommodations for up to 13 in 7 cabins

### 9.1 OWNER

The Master stateroom is on the main deck forward, full beam and is split level.

Entering through a large private office on the starboard side, up a short-fanned stairway to the Master bedroom, providing a 180-degree view of the outdoors. Down the stairs on the port side is the bathroom with Jacuzzi tub and then mid ship is the owner's dressing, with access to both port and starboard. The Master Owner's suite also has a private deck forward with seating and Jacuzzi.

### 9.2 GUESTS

(3) Double cabins on the lower deck, including 2 with bath en suite, 1 with shower en suite.

(2) Twin cabins on the lower deck, including shower en suites.

(1) Large playroom / gym area. This stateroom has a large storage closet for guest luggage and additional stores.

### 9.3 GUEST AREAS

The Main Salon features comfortable seating with large floor to ceiling windows on either side.

Walk forward to the starboard side, where there is the guest lobby and staircase, separating the dining room.

To the port side, pantry area for service-through the dining room, and into the galley (access on both sides).

The Dining Room is separated from the main lounge and again, benefits from full floor to ceiling windows.

Forward is a day head and access to the Galley port side forward before a separate door with access to the Master Owner's suite.

The Upper Deck is an active area for the guests, with vista views from the aft circular window, with a semi-circular sofa. To the port side, there is a lovely bar with seating, and to starboard, a gaming table.

The Upper deck lounge leads out onto the aft deck veranda with alfresco dining.

Forward is access to the Captain's cabin, office and bridge.

The Sun Deck has a lovely circular settee and veranda dining, sunbeds, wet bar and Jacuzzi pool surrounded by padded sun pads.

The tenders are stored on the main deck aft.

The bridge has a comfortable central seating area for guests to view the yacht's operations.

There is also a large swim platform lower deck aft, with easy on-off tender boarding, and clever fast launch jet ski lateral lazarettes. (2) Jet skis (one port, one starboard).

### 9.4 CREW

(1) Captain's cabin with a double bed and en-suite bathroom

(5) Double crew cabins with en-suite bathrooms

(1) Single cabin with en-suite bathroom and office

## 10. KEY FEATURES

- Top Dutch pedigree by Oceanco with timeless design by the "A" Group
- Accommodations for up to 12 guests in 6 well-appointed staterooms plus gymnasium; master stateroom plus 3 doubles, and 2 twins each with ensuites
- Incredible split-level owner's suite, which includes a private study, dressing room, king bed that faces forward plus private outdoor deck with Jacuzzi
- Fully-equipped gym on lower deck
- Versatile deck spaces for outdoor dining and lounging offering open and shaded options
- Jacuzzi on sun deck (in addition to Owner's private Jacuzzi)
- MTU Power provides cruising speed @ 14.5 knots, and max speed up to 16 knots
- 5,100 NM range at 11.5 knots at economical speed
- Lloyds Classification / MCA compliant
- Quantum zero-speed stabilizers
- GRT 643
- Strong Charter History

## 11. REFIT SUMMARY

### 2020

- New 19' Castoldi solas tender plus chase boat
- New carpets and furniture throughout
- New outside furniture
- Two new Jacuzzi's
- 4 Tucchi umbrellas as well as sunshades on sundeck
- Extensive professional gym equipment
- New mattresses and linen
- New curtains in owner's and guest areas
- New art work throughout
- New TV's major improvements to audio and video equipment
- Creston system upgraded
- All new galley equipment
- Starlink, maritime version
- Dedicated gym / massage room
- Many other improvements such as new safes in all staterooms – cutlery glasses etc
- Large Fun Air swimming pool
- Hull and superstructure polished, she looks like new.
- Great variety of new water sport toys
- Main engines and generators fully serviced
- Below waterline fully sandblasted



#### 2019 WINTER WORKS LIST

- MAIN ENGINES: W4, rebuilt the heat exchangers, rebuilt after coolers & borescope / NDT for class
- ZF: endoscopic examination A3 service.
- GENERATORS: W4, new heat exchangers, sea water pumps, thermostats, new vibration mounts, new AVR, borescope investigation for class
- REFRIGERATION PLANT: new compressors, new evaporators, new control board and new refrigeration lines. Completely removed 20-year old system and updated to be 2020 compliant
- UNDER WATER LIGHTNING: New underwater lights LED upgrade
- STABILIZERS: Major overhaul 8000 hrs service from Quantum.
- WATERMAKERS: Completely rebuilt the entire system. New membranes on both units
- FRESH WATER PLANT: Overhaul of the entire system. New cold & hot distribution manifolds, both boilers complete overhauled, all hot water circulators replaced, (3) new GROHE water filtering system for drinking water (no plastic, environmentally friendly), (2) instant boilers in pantries, new Hydrophore pressure tank in stainless steel, fresh water tank painted and (3) new fresh water pumps
- FIRE SPRINKLER SYSTEM: new distribution manifold with test valves, new pump and motor, and new control board on bridge
- BILGE & FIRE PUMPS: both rebuilt with new motors
- TANKS: All cleaned and inspected by Lloyd's
- DECK CRANE: 10-year service. Complete overhaul. New belts, breaks, falls etc.
- ELECTRIC: megger test of motors and heaters, discharge curve for each batteries group
- Wi-Fi: Antenna and 4g system upgraded to Poynting antennas with new Pep wave cellular routers (increased range & speed)
- Phone System: New phone system installed in all cabins, common areas and technical spaces
- Main Engine Start Batteries replaced
- ALFA LAVAL: major service
- BLACK WATER PLANT: Complete overhaul of entire plant. All pumps rebuilt
- GREY WATER PLANT: grey pipeline circuit cleaned
- 20 YEARS SURVEY: Tail Shafts overhauled by manufacturer, Rubber Design. Hull thickness measurement, all through hull valves overhauled and tested, all bilge and fire manifold valves in Engine Room overhauled and tested. Noise and vibration test, main electric distribution board cleaned & insulation tested.

#### 2018

- ANCHOR: (2) NEW
- MAIN ENGINES: complete repainting
- ENGINE ROOM: Deck plates powder coated
- WINDLASSES: both rebuilt
- WATERMAKERS: HP pumps both rebuilt
- TANKS: cleaned and inspected
- E. ROOM VENTILATION FAN: new installed
- Generator start batteries replaced

#### 2016

- MAIN ENGINES: W6 major overhaul
- GENERATORS: W6 major overhaul

#### 2015 REFIT AT MB92

- 15-year Flag and Class survey
- AIR CONDITIONING: New plant installed by Heinen & Hopman
- Painted hull

This document is not contractual. Any information provided by the company on their website, brochure and any other related documentation is provided in good faith and offered for information purposed only and the company do not make any representation, warrant or assume any legal liability or responsibility whatsoever, express or implied, for the accuracy, adequacy, validity, reliability, availability, completeness or usefulness of any information and/or images displayed. Yacht inventory, sales and / or charter prices, and any other specifications are subject to changes at any time without prior notice. None of the text and/or image used in this brochure may be reproduced without written consent from the company.



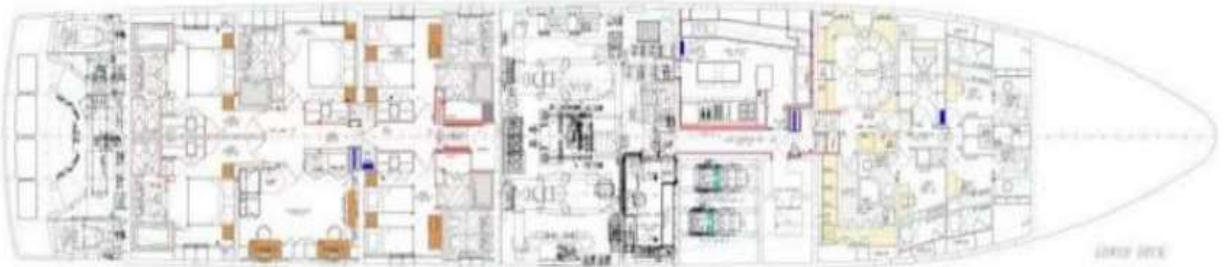
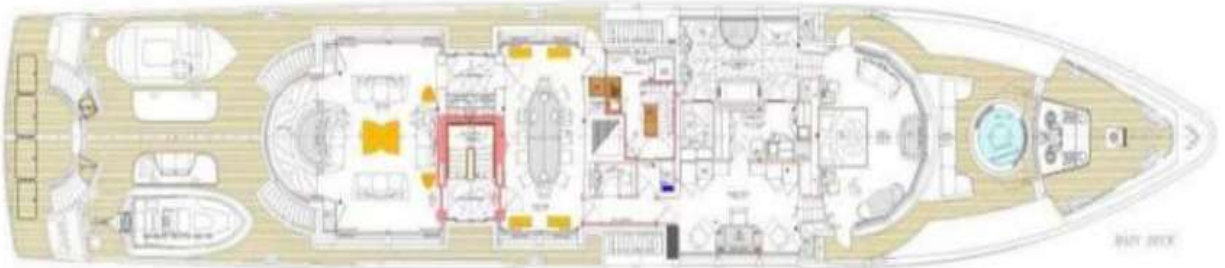
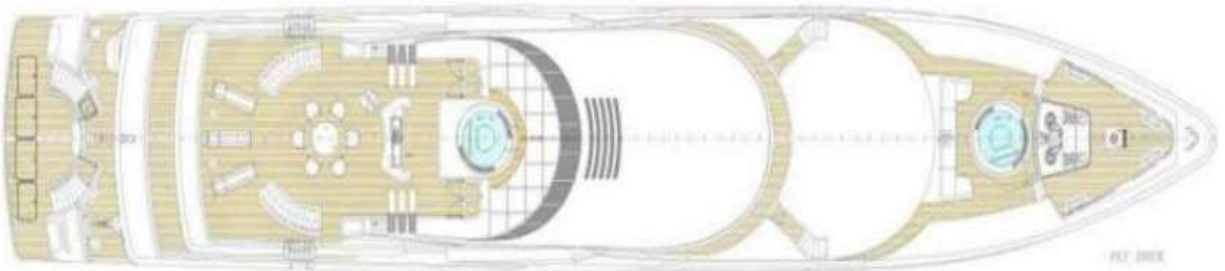



MAIN DECK SALON



SKY LOUNGE











MASTER EN SUITE OFFICE



MASTER EN SUITE





DOUBLE CABIN 1



DOUBLE CABIN 2



KITCHEN



BRIDGE DECK AFT









SUN DECK JACUZZI



SUN DECK

