

2020 Monte Carlo Yachts MCY70 Sky Lounge

EUR 3,500,000



| | | | |
|----------------|------------------|--------------|-------------------------|
| Length Overall | 34 M | Engine | 2 X Man V8 1300 V-Drive |
| Beam | 7.4 M | Engine Hours | N/A |
| Draft | 2.21 M | Drive Type | Shaft drive system |
| Cabins | 4 | Fuel Tank | 4,000 L |
| Hull Material | Fiberglass | Water Tank | 800 L |
| Location | Phuket, Thailand | Builder | Monte Carlo Yachts |

MAIN SYSTEMS / ELECTRICAL

- / Extra Tropical Air Conditioning (including crew quarters)
- / 24 V /220 V inverter - 2,5 kW
- / Upgrade to 2 x 19 kW generators
- / Stern Thruster (electric)
- / Bow Thruster (electric)
- / Flaps
- / Humphree interceptors with Automatic Trim
- / Searchlight
- / Gyro stabilizer system (in lieu of stabilizer fins)
- / Engine, Generator oil change system
- / Double Racor filters for engines
- / Racor filters for generator
- / Engine driven emergency bilge pump
- / Automatic fire fighting system
- / Water maker 220 l/h
- / Megayachts underwater lights (3)
- / Concealed lights for front cockpit area

EXTERIORS

- / Hydraulic Up/down lifting platform with gross loading capacity up to 1.764 lb
- / Semi-automatic electric weathertight door from saloon to starboard sideway
- / Doors for side access (2)
- / Teak floor on cockpit
- / Teak floor on sideways
- / Teak floor on bathing platform
- / Teak floor on fly bridge
- / Sideways teak handrails
- / Additional cleats on aft deck
- / Additional cleats on sides close to bow sun pads
- / Aft cockpit armchairs (3 units)
- / Teak armchairs for fly bridge (per unit)
- / FULL boat cover
- / Aft Cockpit cover
- / Teak tables (1 for aft cockpit with fixed legs, 2 for front cockpit with electrically adjustable legs)
- / Teak table electric electrically adjustable legs (per aft cockpit table)
- / Panoramic sunroof with electric opening glass panel
- / Light system for crystal fashion plates
- / Front Cockpit cover
- / Closing for Aft Cockpit (on main deck)
- / Sun pad, sofas and table covers
- / External cushions
- / Hull and aft side deck painting (it does not include custom full yacht painting)
- / Flag stem
- / Aft access to engines room /crew quarters
- / Dock side water inlet



INTERIORS

- / Miele (or equivalent) appliances (oven, galley extractor, hobs)
- / Additional separate freezer (65 liters) + 260 liters fridge in lieu of standard refrigerator with freezer
- / Refrigerator with freezer (190 litres)
- / Dish washer
- / Washer & dryer
- / Fridge on enclosed bridge
- / Ice maker on enclosed bridge
- / Dimmers for main deck saloon, cockpit lights and enclosed saloon
- / Portholes mosquito nets
- / Wood floor on main deck saloon and enclosed saloon
- / Memory foam mattresses
- / Safe box in owner's cabin
- / Sliding beds in port guest cabin
- / Tecma seats
- / LED light system
- / Decor Extra Luxe
- / Roman blinds

AUDIO / VIDEO

- / Home Theatre System - for main deck saloon (remote control and speakers also on aft cockpit)
- / LED TV for owner's cabin
- / LED TV for main deck saloon (concealed into saloon ceiling)
- / Fusion Stereo on enclosed bridge saloon
- / Fusion Stereo for bow lounge area
- / Upgrade to Audio systems and Home Theatre - Sonos System for interiors and exteriors

HELM / NAVIGATION ELECTRONICS

- / 3 x 16 GARMIN chartplotter displays with Radar/GPS chartplotter and integrated monitoring system
- / Garmin Radar Antenna (Radome)
- / Flaps indicators
- / Chain counters
- / Garmin Tridata
- / AIS Receiver + Transceiver
- / Garmin Auto Pilot
- / Garmin VHF
- / Videocamera (aft cockpit and engine room)
- / 2 x additional cameras on port and stdb side
- / 4G router and Wi-Fi network

This document is not contractual. Any information provided by the company on their website, brochure and any other related documentation is provided in good faith and offered for information purposed only and the company do not make any representation, warrant or assume any legal liability or responsibility whatsoever, express or implied, for the accuracy, adequacy, validity, reliability, availability, completeness or usefulness of any information and/or images displayed. Yacht inventory, sales and / or charter prices, and any other specifications are subject to changes at any time without prior notice. None of the text and/or image used in this brochure may be reproduced without written consent from the company.

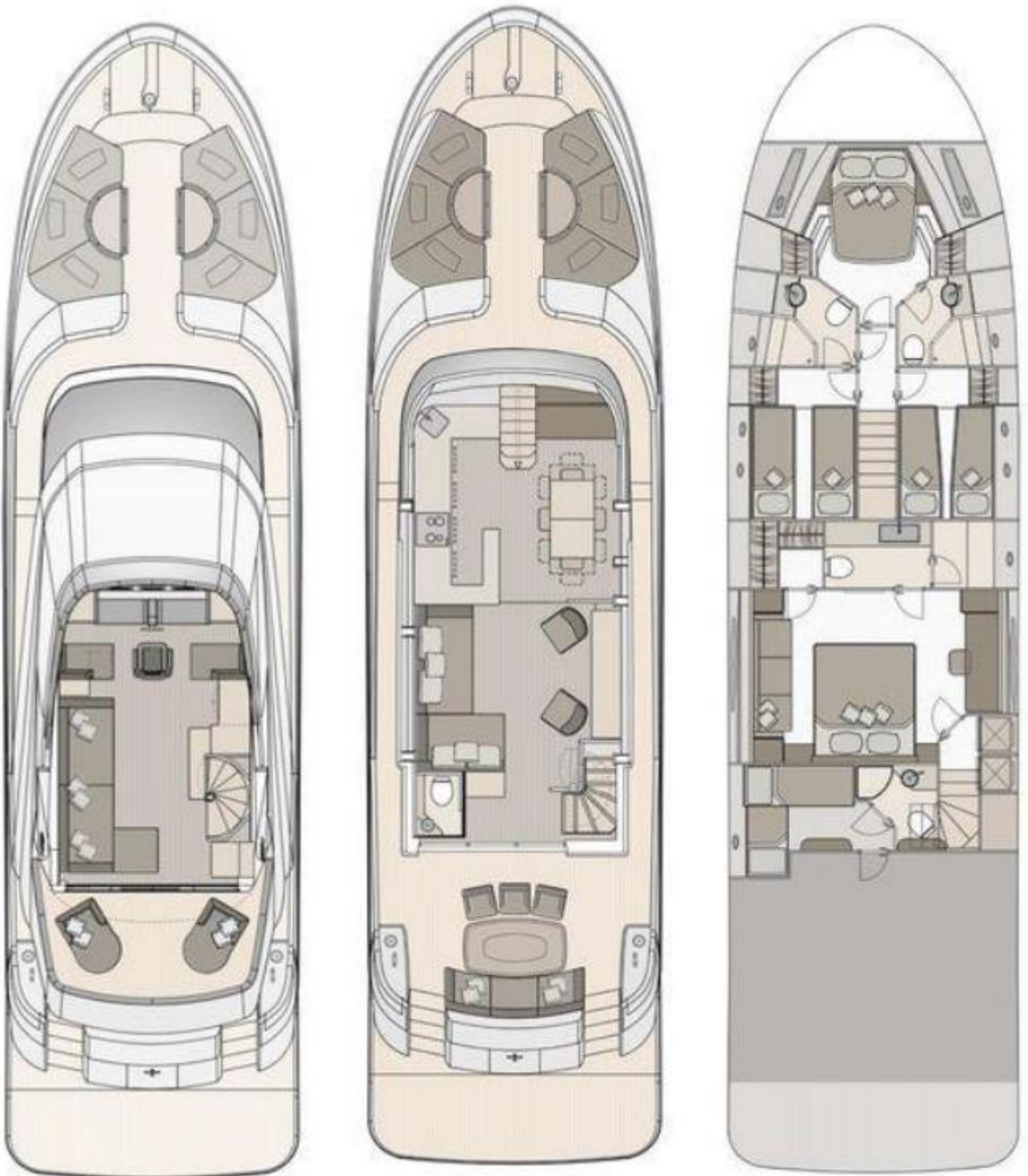



EXTERIOR LIVING
Front Deck Lounge Area



EXTERIOR LIVING
Aft Deck





INTERIOR LIVING
Saloon



INTERIOR LIVING
Galley



INTERIOR LIVING
Glass Stairway to Sky Lounge



INTERIOR LIVING
Sky Lounge



Cabin arrangement
Master cabin



Cabin arrangement
VIP cabin



Cabin arrangement
Twin cabin



Cabin arrangement
Master bathroom



Cabin arrangement
Guest Bathroom